

CHEMICAL SAFETY MOMENT

Issue 19 – January 2017

BioRAFT student roster – Are you adding students to your lab this semester? Please email Tracy

Evacuation Meeting Locations

How to Triple Rinse a container

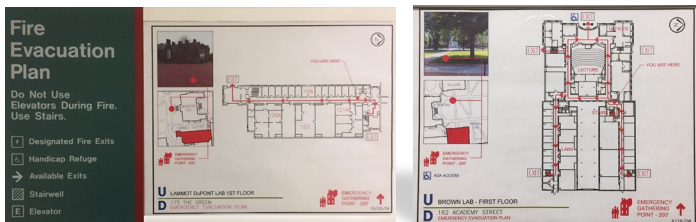

Over the past few weeks several incorrectly “triple rinsed” containers have been placed in the blue compactor. What is the proper method?

1. Triple rinse with copious amounts of water. Collect the first rinse as chemical waste. Rinse two and three can go down the sanitary sewer.
2. Place a label over the original container label or deface the label and write **empty and triple rinse**.
3. Do not replace the cap on the container.

Do you know where to meet if there was a **fire** or **building emergency**? Take a look at the building evacuation maps located in each hallway, they will show you the exact location.

Place empty/triple rinsed containers in a lab trash box or directly into the blue compactor.

- **Brown Lab** meets at Hullahen Hall
- **Lammot du Pont** meets at Memorial Hall
- **Drake Lab** meets at Colburn Lab



Once you are at the meeting spot please DO NOT leave, but check-in with the person in charge. You need to be accounted for and you may have information that can aid first responders during the emergency situation.

If you have any questions about what to do, or where to go during an emergency, please ask!

